



Global Jet Sales

Corporate Trading, Inc.

111 Second Ave. NE, Suite 103
St. Petersburg, FL 33701
727.864.9443 ~ Fax 727.864.9448

3775 Flight Avenue, Suite 204
Redding, CA 96002
530.226.3399 ~ Fax 530.226.3398

www.JetSearch.com ~ sales@JetSearch.com

2003 Citation Excel s/n 5346



**Enrolled on all Major Maint. Prog's
Dual RM-850/855 RMU
1 Corp. Owner Since New
2841 AFTT**

**Contact: Alexander Janas
sales@jetsearch.com**



Global Jet Sales

Corporate Trading, Inc.

sales@JetSearch.com
111 2nd Ave NE Suite 103
Saint Petersburg FL 33701
727-864-9443

3775 Flight Avenue Suite 204
Redding CA 96002
530-226-3399
www.JetSearch.com

2003 CIT XL S/N: 5346

\$MAKE OFFER

AirFrame PROPRTS

2841 Hours since New
1762 Landings

Engines

Engine 1
Engine 2

P&W -545A

2747 SNEW
2679 SNEW

PADV

170 SHS
170 SHS

Auxiliary Power Unit

HONEYWELL RE100XL AUXAD

1115 Total Time

Avionics

3 Tube HONEYWELL PRIMUS 1000 EFIS
2 HONEYWELL RCZ-833E/TR-850 COMMS
2 HONEYWELL RNZ-850 NAV'S
2 HONEYWELL DF-850 ADF
2 HONEYWELL DM-850 DME
2 HONEYWELL RCZ-833 MODE S TDR
1 HONEYWELL WU-880 RADAR
1 UNIVERSAL UNS-1ESP FMS
1 HONEYWELL KHF-950 W/SELCA HF

HONEYWELL CAS-67A W/CHG 7 TCAS
ARTEX C-406-2 W/NAV INTRF ELT
AIRCELL AST-3500 AIRPHONE
HONEYWELL MARK V EGPWS
L3 FA-2100 CVR

Special Features

CESCOM
CONV TO MSG3 10/08
CAMP
APU HOBBS IN CKPT
HNYWLL AA-300 RA
UNIVERSAL SSDTU
2ND MEGGITT FLIGHT DISPL
PULSE LIGHT SYSTEM

DUAL LCR-93 AHRS
UNIVERSAL UL-701 UNILINK
DUAL HNWYLL RM-850/855 RMU
NICKEL CAD MAIN BATTERY
HNYWLL IAC IC-600
AVNCS DSPTCH GRND PWR SWITCH
DUAL HONEYWELL AZ-850 ADS
AUDIO CHCKLST/CABIN BRIEFER

PHASE 5 C/W 10/06
GR WHT INC 200LB C/W 6/06
B&D 2700 CABIN INFO DISP
SAFEFLIGHT UC-009 AOA SYS
DUAL DAVTRON CLOCKS
ELCTRNC ENG CHIP DETECTOR
CKPT SPEAKER MUTE SWITCH

Exterior 08/2003

OVERALL WHITE W/BLUE & PLATINUM STRIPES.

Interior 08/2003

EIGHT PLACE FIREBLOCKED INTERIOR W/FWD 2-PLACE DIVAN, MID DBL CLUB AND AFT 2 SINGLE FWD FACING SEATS. SEATS AND DIVAN IN LIGHT TAN LEATHER, BEIGE HEADLINER & SIDEWALLS, DARK BROWN LEATHER CUP RAILS, DARK BROWN CARPET & WALNUT WOODWORK. L/H FWD GALLEY W/PREPCO COFFEE MAKER. L/H FWD CLOSET AND AFT CENTERLINE CLOSET. ENTERTAINMENT WITH AIRSHOW AVVISOR 15001, B&D 2700 CABIN INFORMATION SYSTEM. AFT LAV W/VANITY. EXTERNAL BAGGAGE. (2)110 VAC OUTLETS. FAX/DATA PORT.

Weights

MTOGW: 20,200	RAMP: 20,400	ZFW: 15,100	LANDING: 18,700
BOW: 13,033	EMPTY: 12,423	FUEL WT: 6,790	FUEL CAP: 976



Global Jet Sales

Corporate Trading, Inc.

111 Second Ave. NE, Suite 103
St. Petersburg, FL 33701
727.864.9443 ~ Fax 727.864.9448

3775 Flight Avenue, Suite 204
Redding, CA 96002
530.226.3399 ~ Fax 530.226.3398

www.JetSearch.com ~ sales@JetSearch.com

Exterior



Cockpit



Global Jet Sales

Corporate Trading, Inc.

111 Second Ave. NE, Suite 103
St. Petersburg, FL 33701
727.864.9443 ~ Fax 727.864.9448

3775 Flight Avenue, Suite 204
Redding, CA 96002
530.226.3399 ~ Fax 530.226.3398

www.JetSearch.com ~ sales@JetSearch.com

**Interior
Fwd**





Global Jet Sales

Corporate Trading, Inc.

111 Second Ave. NE, Suite 103
St. Petersburg, FL 33701
727.864.9443 ~ Fax 727.864.9448

3775 Flight Avenue, Suite 204
Redding, CA 96002
530.226.3399 ~ Fax 530.226.3398

www.JetSearch.com ~ sales@JetSearch.com

**Interior
Aft**





Global Jet Sales

Corporate Trading, Inc.

111 Second Ave. NE, Suite 103
St. Petersburg, FL 33701
727.864.9443 ~ Fax 727.864.9448

3775 Flight Avenue, Suite 204
Redding, CA 96002
530.226.3399 ~ Fax 530.226.3398

www.JetSearch.com ~ sales@JetSearch.com

Galley



Lav



ESTIMATED VARIABLE COSTS - Per Hour

Citation Excel

Fuel (1)	\$1,667.50
Fuel Additives	
Lubricants	
Maintenance Labor (2)	108.81
Parts Airframe/Eng/Avion (3)	125.89
Engine Restoration (4)	336.42
Thrust Reverser Allowance	
Propeller Allowance	
APU Allowance	34.81
Major Periodic Maintenance	
Misc Exp. - Landing/Parking	20.52
- Crew Expenses	89.56
- Supplies/Catering	47.22
- Carbon Offset (5)	
- Other	
Fractional Fuel Surcharge Cost/Hour + Tax	
Fractional Cost/Hour + Tax	
Total Variable Cost/Hour	\$2,430.74
Cost per Nautical Mile	\$6.14
Average Speed-Kts. (6) 600-nm trip	396.00

Cost data in this report is intended to be used as a benchmark

FOOTNOTES - Size of Operation: 1 - 2 Aircraft

Date: 2/14/2012

Currency: \$

Type of Operation:	Corporate
1. Fuel Cost	6.67
Gallons/Hour Blk Fuel/Flt Time +15%	250
2. Maint. Labor Cost per Hour	93
Maint. Hours/Flight Hours	1.17
3. Incl. Engine Parts Cost	No
Engine Model	PW545C
Aircraft Model Year	2004
4. Overhaul Cost Source	JSSI Prem11
5. CO2 Cost Per Tonne	
6. Block Speed Source	Mftr Data



ANNUAL FIXED COSTS

Citation Excel

Crew salaries - Captain (7)	\$109,000
- Co Pilot	77,000
- Flt Attendant	
- Flt Eng/Other	
- Benefits	55,800
Hangar - Typical	38,000
Insurance - Hull (8)	10,200
Single Limit Liability	10,500
<hr/>	
Recurrent Training	31,200
Aircraft Modernization (9)	35,000
Navigation Chart Service	4,579
Refurbishing (10)	26,040
Computer Mx. Program (11)	2,700
Weather Service (12)	700
Other Fixed Costs	
Mgmt Fee/Yr	
Total Fixed Cost/Year	\$400,719

Cost data in this report is intended to be used as a benchmark

FOOTNOTES - Size of Operation: 1 - 2 Aircraft

Date: 2/14/2012

Currency: \$

7. Crew Salary Source	10 NBAA
Number of Crew	2
8. Ins Hull Value/Frac Share Cost	5,100,000
Hull Insurance Rate (%)	0.20
9. Modernization	10 Yr Avg
10. Refurbish Labor Hrs/Seat	40
11. Comp. Mx Program Source	Typical
12. Weather Service Source	Typical



ANNUAL BUDGET

Citation Excel

Utilization - Nt. Miles	175,000
- Hours	442
Variable Cost	1,074,385
Fixed Cost	400,719
Total Cost (No Depreciation)	\$1,475,104
- Per Hour	3,337.00
- Per Nt. Mile	8.43
- Per Seat Nt. Mile	1.20
Total Cost (No Depreciation)	1,475,104
Book Depreciation (13)	510,000
Total Cost (Book Dep)	\$1,985,104
- Per Hour	4,491.00
- Per Nt. Mile	11.34
- Per Seat Nt. Mile	1.62
Total Cost (No Depreciation)	1,475,104
Market Depreciation (14)	204,000
Total Cost (Market Dep.)	\$1,679,104
- Per Hour	3,799.00
- Per Nt. Mile	9.59
- Per Seat Nt. Mile	1.37

Cost data in this report is intended to be used as a benchmark

Footnotes - Size of Operation: 1 - 2 Aircraft

Date: 2/14/2012

Currency: \$

13. Book Depreciation Rate 10% per yr

14. Market Depreciation Rate 4.00



GENERAL COMPARISON

Citation Excel

Cabin-Height (Ft.)	5.70
- Width	5.50
- Length	18.50
Cabin volume (Cu. Ft.)	461.00
Cabin Door Height (Ft.)	4.54
- Width	2.00
Baggage -Int. (Cu.Ft.)	10.00
- External	80.00
Typical Crew/Pass Seating	2/7
<hr/>	
Weight-Max Take-off (Lbs.)	20,000
- Maximum Landing	18,700
- Basic Operating	12,500
- Usable Fuel	6,740
Payload-Full Fuel (Lbs.)	960
- Maximum	2,500
<hr/>	
Certified	Yes
IFR Certified	Yes
<hr/>	
Price - New (Corporate)/1000	10,270
- Pre Owned Rng/1000	3,300/5,100
- Years Produced	1998 - 2004



PERFORMANCE COMPARISON

Citation Excel

Range-NBAA IFR Res (N.Mi.)	
Seats Full	1,449
Ferry Range - (Pilot(s) only, no pax)	1,839
<hr/>	
Range-30 Min. Res (N.Mi.)	
Seats Full	
Ferry Range - (Pilot(s) only, no pax)	
Balanced Field Length (Ft.)	4,060
Landing Field Length - FAR 91	2,950
Landing Field Length - FAR 121	4,917
Landing Field Length - FAR 135	3,688
<hr/>	
Rate Of Climb (Ft/Min)	3,790
- One Engine Out	699
<hr/>	
Cruise Speed-Max (KTAS)	433
- Normal	433
- Long Range	373
Stall Speed (IAS)	81
<hr/>	
Ceiling-Service MTOW (Ft.)	44,000
- Certified	45,000
- Service OEI	28,600
- Hover IGE (Helicopter Only)	
- Hover OGE (Helicopter Only)	

EXTERIOR

Scale = 1:150

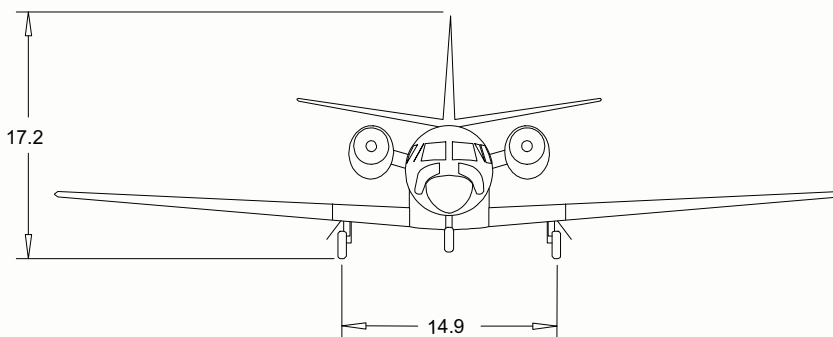
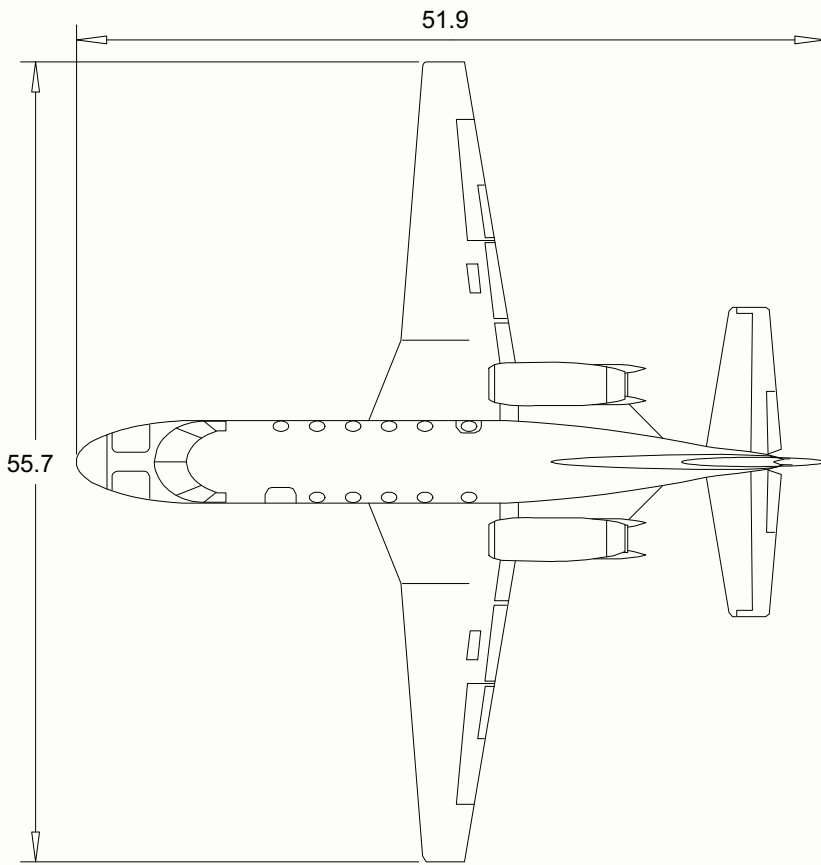
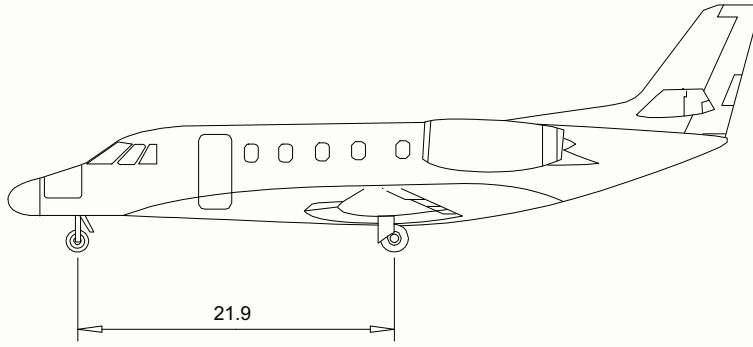

All dimensions are measured in Feet unless otherwise specified.

INTERIOR

Orleans, Massachusetts (508)255-5975

© 2006 Conklin & de Decker Associates, Inc.

Scale = 1:30

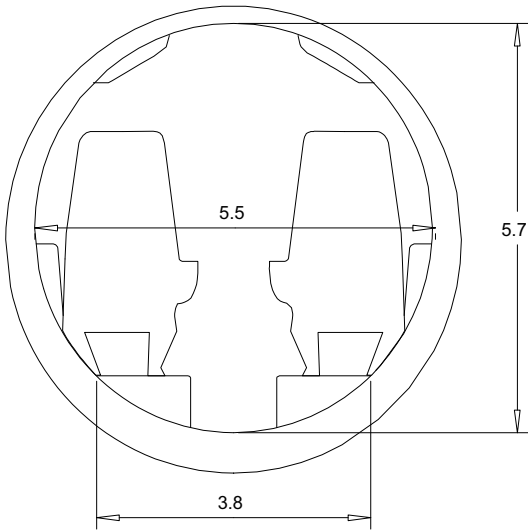

Citation Excel

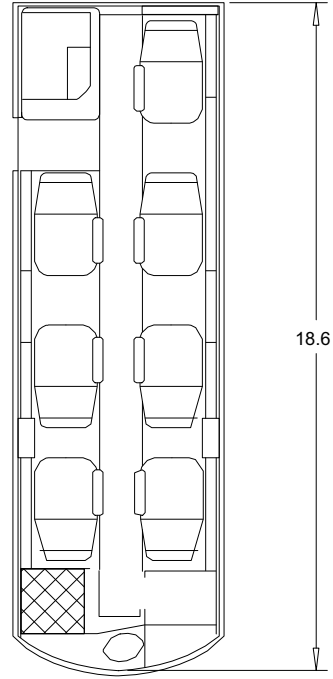

Scale = 1:60

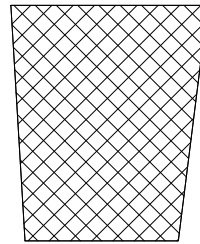

 - Baggage

All dimensions are measured in Feet unless otherwise specified.



Cessna Citation Excel

The Citation Excel combines a shortened Citation X cabin that seats seven with a modified Citation V wing.

The Excel is equipped with Pratt & Whitney PW545A engines that have Nordam thrust reversers. The Excel is equipped with a Honeywell Primus 1000 EFIS avionics package and has a range of about 1,700 NM.

The Excel's first flight was on February 29, 1996. Certification was received in 1998. The aircraft was in production till 2004, when the Citation XLS replaced it.